

COPPER BELLMOUTH LUGS 6mm²-120mm²

CABAC's Bell Mouth Lug range is specifically designed to accommodate fine stranded flexible conductors. Because fine stranded cables have a larger diameter than normal cables, and they tend to splay out after stripping, CABAC has developed this range of lugs, which funnel the strands into the lug and make conductor insertion easy.

At the top end of the range, around 150 to 240mm² some manufacturers cables will not fit into the nominal lug. In this case CABAC recommends using one lug size up, and using a special crimping method, described on the next page. CABAC has done tests on various manufacturers cables, and tables defining fitment of cables are available from our sales desk.

Please contact CABAC for assistance.

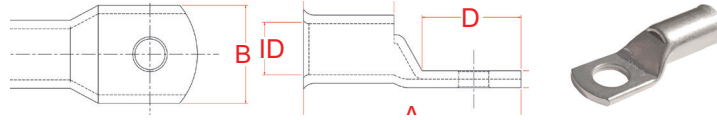

Part No.	Nominal Conductor (mm ²)	ID Size (mm)	Stud Size (mm)	A (mm)	B (mm)	C (mm)	D (mm)	E (mm)	A/F Hex Die (mm)	No. Crimps	Crimp Die	Unit	Qty
CAL6-6BM	6	3.8	6	27	12	1	15	9	4.4	1	-	EA	1
CAL6-8BM	6	3.8	8	27	12	1	15	9	4.4	1	-	EA	1
CAL6-10BM	6	3.8	10	32	16	0.8	20	9	4.4	1	-	EA	1
CAL10-6BM	10	4.7	6	27	12	1.8	14	10	5.7	1	-	EA	1
CAL10-8BM	10	4.7	8	29	14	1.5	16	10	5.7	1	-	EA	1
CAL10-10BM	10	4.7	10	32	16	1.3	19	10	5.7	1	-	EA	1
CAL10-12BM	10	4.7	12	37	18	1.2	23	10	5.7	1	-	EA	1
CAL16-6BM	16	5.5	6	37	11	2.3	14	19	6.3	1	HT130-C-16	EA	1
CAL16-8BM	16	5.5	8	39	14	1.7	16	19	6.3	1	HT130-C-16	EA	1
CAL16-10BM	16	5.5	10	41	16	1.5	18	19	6.3	1	HT130-C-16	EA	1
CAL16-12BM	16	5.5	12	46	18	2.4	23	19	6.3	1	HT130-C-16	EA	1
CAL25-6BM	25	7.1	6	41	14	2.4	16	21	7.7	1	HT130-C-25	EA	1
CAL25-8BM	25	7.1	8	41	14	2.4	16	21	7.7	1	HT130-C-25	EA	1
CAL25-10BM	25	7.1	10	44	16	2	19	21	7.7	1	HT130-C-25	EA	1
CAL25-12BM	25	7.1	12	46	18	1.6	23	21	7.7	1	HT130-C-25	EA	1
CAL35-6BM	35	8.2	6	44	16	3	18	21	9.2	1	HT130-C-35	EA	1
CAL35-8BM	35	8.2	8	44	16	3	18	21	9.2	1	HT130-C-35	EA	1
CAL35-10BM	35	8.2	10	46	18	2.6	20	21	9.2	1	HT130-C-35	EA	1
CAL35-12BM	35	8.2	12	50	20	2.3	24	21	9.2	1	HT130-C-35	EA	1
CAL50-6BM	50	9.5	6	48	18	3.2	20	22	10.4	1	HT130-C-50	EA	1
CAL50-8BM	50	9.5	8	48	18	3.2	20	22	10.4	1	HT130-C-50	EA	1
CAL50-10BM	50	9.5	10	48	18	3.2	20	22	10.4	1	HT130-C-50	EA	1
CAL50-12BM	50	9.5	12	52	21	2.7	24	22	10.4	1	HT130-C-50	EA	1
CAL70-6BM	70	11.2	6	54	21	3.3	24	24	11.5	1	HT130-C-70	EA	1
CAL70-8BM	70	11.2	8	54	21	3.3	24	24	11.5	1	HT130-C-70	EA	1
CAL70-10BM	70	11.2	10	54	21	3.3	24	24	11.5	1	HT130-C-70	EA	1
CAL70-12BM	70	11.2	12	54	21	3.3	24	24	11.5	1	HT130-C-70	EA	1
CAL95-8BM	95	13.4	8	60	25	3.9	26	27	14.2	1	HT130-C-95	EA	1
CAL95-10BM	95	13.4	10	60	25	3.9	26	27	14.2	1	HT130-C-95	EA	1
CAL95-12BM	95	13.4	12	60	25	3.9	26	27	14.2	1	HT130-C-95	EA	1
CAL95-16BM	95	13.4	16	64	28	3.4	30	27	14.2	1	HT130-C-95	EA	1
CAL120-8BM	120	15.6	8	64	29	5	26	30	16.5	1 round, 2 compacted	HT130-C-120	EA	1
CAL120-10BM	120	15.6	10	64	29	5	26	30	16.5	1 round, 2 compacted	HT130-C-120	EA	1
CAL120-12BM	120	15.6	12	64	29	5	26	30	16.5	1 round, 2 compacted	HT130-C-120	EA	1
CAL120-16BM	120	15.6	16	68	29	5	30	30	16.5	1 round, 2 compacted	HT130-C-120	EA	1

	Tooling	Part No.
INDENT	HN1, HN2	CAL6-6BM to CAL10-10BM
	K10/3	CAL6-6BM to CAL6-10BM
	K25, K26, K27	CAL6-6BM to CAL16-12BM
	K28	CAL6-6BM to CAL25-12BM
	K05	CAL6-6BM to CAL50-12BM
HEX	K06, K06C, B035	CAL6-6BM to CAL50-12BM
	HT51, B51	CAL6-6BM to CAL50-12BM
	HT131-C, HT131LN-C, HT131-UC, RHC131, RHU131-C, B131-C, B131LN-C, B135-C, CY0-510B	CAL16-6BM to CAL70-12BM
	ECW-H3D, (TO 630MM2) RHU520	CAL16-6BM to CAL120-16BM

In support of our policy of continuous product improvement we reserve the right to change materials and specifications without notice. Drawings, where used, are not to scale. All dimensions are in millimetres and sizes given are approximate. Where possible, technical MSDS data sheets are made available on the website. All products should be installed and used in accordance with manufacturer's instructions provided. Warning: products may be the subject of registered designs and patents. Refer to website for terms and conditions on warranty.

COPPER BELLMOUTH LUGS 150mm²-500mm²

CABAC's Bell Mouth Lug range is specifically designed to accommodate fine stranded flexible conductors. Because fine stranded cables have a larger diameter than normal cables, and they tend to splay out after stripping, CABAC has developed this range of lugs, which funnel the strands into the lug and make conductor insertion easy.

At the top end of the range, around 150 to 240mm² some manufacturers cables will not fit into the nominal lug. In this case CABAC recommends using one lug size up, and using a special crimping method, described on the next page. CABAC has done tests on various manufacturers cables, and tables defining fitment of cables are available from our sales desk.

Please contact CABAC for assistance.

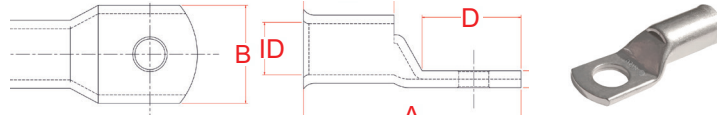

Part No.	Nominal Conductor (mm ²)	ID Size (mm)	Stud Size (mm)	A (mm)	B (mm)	C (mm)	D (mm)	E (mm)	A/F Hex Die (mm)	No. Crimps	Crimp Die	Unit	Qty
CAL150BM	150	16.7	-	71	32	5.5	32	30	18.3	2	HT130-C-150	EA	1
CAL150-8BM	150	16.7	8	71	32	5.5	32	30	18.3	2	HT130-C-150	EA	1
CAL150-10BM	150	16.7	10	71	32	5.5	32	30	18.3	2	HT130-C-150	EA	1
CAL150-12BM	150	16.7	12	80	32	5.5	41	30	18.3	2	HT130-C-150	EA	1
CAL150-16BM	150	16.7	16	80	32	5.5	41	30	18.3	2	HT130-C-150	EA	1
CAL185-10BM	185	18.4	10	74	35	5.7	32	32	20	2	HT130-C-185	EA	1
CAL185-12BM	185	18.4	12	83	35	5.7	41	32	20	2	HT130-C-185	EA	1
CAL185-16BM	185	18.4	16	83	35	5.7	41	32	20	2	HT130-C-185	EA	1
CAL240BM	240	21.2	-	92	40	7.1	42	38	23.1	3	HT130-C-240	EA	1
CAL240-10BM	240	21.2	10	92	40	7.1	42	38	23.1	3	HT130-C-240	EA	1
CAL240-12BM	240	21.2	12	92	40	7.1	42	38	23.1	3	HT130-C-240	EA	1
CAL240-16BM	240	21.2	16	92	40	7.1	42	38	23.1	3	HT130-C-240	EA	1
CAL300BM	300	23.5	-	101	45	7.8	46	42	26	3	HT130-C-300	EA	1
CAL300-10BM	300	23.5	10	101	45	7.8	46	42	26	3	HT130-C-300	EA	1
CAL300-12BM	300	23.5	12	101	45	7.8	46	42	26	3	HT130-C-300	EA	1
CAL300-16BM	300	23.5	16	101	45	7.8	46	42	26	3	HT130-C-300	EA	1
CAL400BM	400	26.8	-	114	50	7.7	52	44	28.1	3	HT130-C-400	EA	1
CAL400-12BM	400	26.8	12	114	50	7.7	52	44	28.1	3	HT130-C-400	EA	1
CAL500BM	500	31.5	-	128	56	7.5	56	50	31	2	ECW-H3D-500	EA	1
CAL500-12BM	500	31.5	12	128	56	7.5	56	50	31	2	ECW-H3D-500	EA	1
CAL500-16BM	500	31.5	16	128	56	7.5	56	50	31	2	ECW-H3D-500	EA	1

Tooling

ECW-H3D, (TO 630MM2) RHU520

Part No.

CAL150BM to CAL500-16BM

HEX

In support of our policy of continuous product improvement we reserve the right to change materials and specifications without notice. Drawings, where used, are not to scale. All dimensions are in millimetres and sizes given are approximate. Where possible, technical MSDS data sheets are made available on the website. All products should be installed and used in accordance with manufacturer's instructions provided. Warning: products may be the subject of registered designs and patents. Refer to website for terms and conditions on warranty.