

CLP5010WDZ  
PDL5010WDZ



## Wisier™ Micro Module



LED	5-100 VA RC
Dimmable LED	5-20 VA RL
Incandescent	14-200 W
Iron core transformer	14-150 VA

AC Halogen	14-150 W
Electronic transformer	14-200 VA

**i** RC: Resistive-capacitive load  
RL: Resistive-inductive load

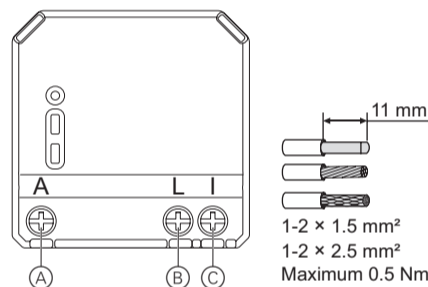
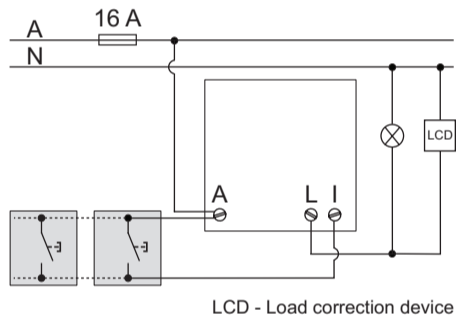
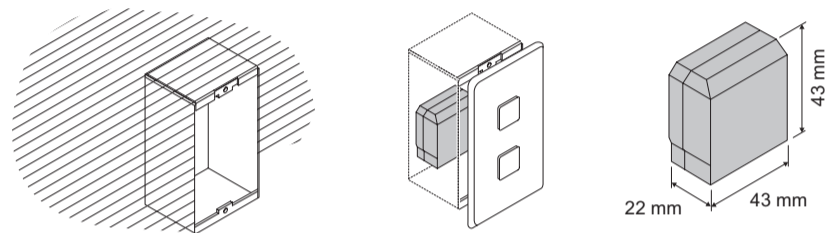

### Pairing

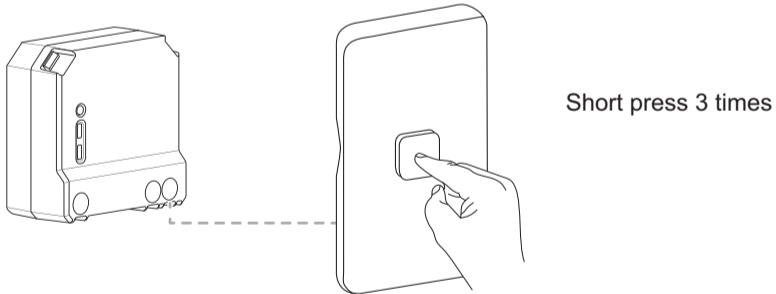

### Restoring the device to factory default

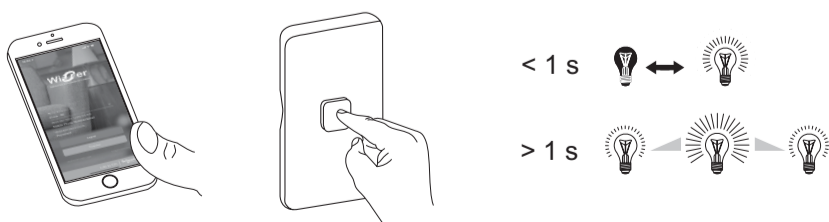
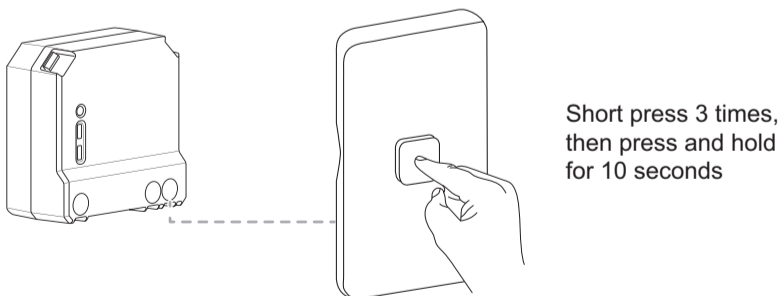

## Wisier Micro Module Dimmer

### Prerequisites

Download the **Wisier™ by SE App** to your smartphone and install the **Wisier Hub** to configure and control Wisier devices.

### Additional system information

Detailed product information is available online in the **system user guide**: Scan the QR code for your region.

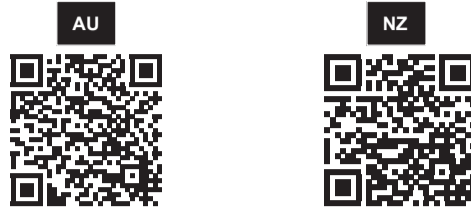

### For your safety

#### ⚠️ DANGER

#### HAZARD OF ELECTRIC SHOCK, EXPLOSION, OR ARC FLASH

- It is illegal for persons other than an appropriately licensed electrical contractors or other persons authorised by legislation to work on the fixed wiring of any electrical installation.
- To comply with all safety standards, the product must be used only for the purpose described in this instruction and must be installed in accordance with the wiring rules and regulation in the location where it is installed.
- Lock out and tag the input circuit before accessing the wiring connections.
- There are no user serviceable parts inside the product.

**Failure to follow these instructions will result in death or serious injury.**

### Getting to know the product

The Wisier micro module dimmer (hereinafter referred to as **dimmer module**) is used to switch and dim resistive, inductive or capacitive loads.

**i** The dimmer module must not be used to control safety relevant applications.

### Control options

**Home control:** To control the dimmer module through the **Wisier by SE App** you will need the Wisier Hub.

**Direct operation:** The dimmer module can always be controlled directly on-site. To do this, you can connect a maximum of 10 push buttons (see "Push button reference").

### Functions

- Automatic load detection
- Thermal protection, overload-resistance, short-circuit protection
- Soft start/stop

### Via App:

- Adjusting minimum/maximum brightness
- Setting the LED operating mode manually
- Setting the switch-on brightness or memory function
- Setting a timer or a time schedule

### Push button reference

Description	Catalogue numbers
Momentary push button	41EPBM-VW, 356PBSS-VW
Mechanical push button	60PBBP, 30PBBP

### Choosing the installation location

- If placing the dimmer module behind a push button, use a suitable wall box.
- To reduce the thermal dissipation, reduce the load.

Reduce load by	When installed
0%	In a standard flush-mounted box
25%	In cavity walls* Several installed in combination*
30%	In a 1-gang or 2-gang surface mounted housing
50%	In a 3-gang surface-mounted housing

\* If more than one factor applies, add load reductions together.

### Connection elements

- (A) Active conductor
- (B) Dimmer output
- (C) Extension unit input 1

### Mounting the dimmer module

#### ⚠️ DANGER

#### HAZARD OF ELECTRIC SHOCK

- Make sure that the terminal connection area does not come in contact with the metallic parts of any device installed in the same location.
- Do not short the outputs to neutral.

**Failure to follow these instructions will result in death or serious injury.**

#### ⚠️ CAUTION

#### EQUIPMENT DAMAGE

- Always operate the product in compliance with the specified technical data.
- Never connect any mixed inductive/capacitive loads.
- Connect only dimmable loads.
- Do not use dimmable socket outlets.

**Failure to follow these instructions can result in injury or equipment damage.**

### Connecting the dimmer module



#### ⚠️ DANGER

#### RISK OF ELECTRIC SHOCK, EXPLOSION OR ARC FLASH

- When working on the device, always disconnect the device from the power supply, as the output may carry electrical current even when the load is switched off.
- Isolate the incoming circuit before installation, maintenance, or service (or replacement of the load) of the device.

**Failure to follow these instructions will result in death or serious injury.**



The dimming result will depend on the LED connected. Some LEDs may not work as expected. This depends on number of LEDs, the type of driver and the power quality supplied from the network. A 31LCDA may resolve the issues. A 31LCDA is required if using a single LED. Flicker can occur at certain times of the day due to increased ripple signals in the network. In this case contact the supply authority.

### Setting the dimmer module

#### Pairing to the Wisier Hub

Short press (< 0.5 s) the connected push-button switch 3 times to connect to the available Zigbee network

#### Resetting the dimmer module

Short press (< 0.5 s) the connected push-button switch 3 times and then long press the push-button switch once for >10 s and <15 s to reset the dimmer module to factory default mode.

All configuration data, user data, and network data are deleted. After which:

- No connectivity to other devices
- No time schedule (s)
- Memory function is active
- Automatic load detection is active, RC mode is set
- No limitation to dimming range

### Operating the dimmer module

You can remotely control the blind controller module through the **Wisier by SE App** or locally by using a momentary switch.

### Troubleshooting

Refer to the system user guide.

### Technical data

Nominal voltage	AC 220-240 V, 50/60 Hz
Nominal power	
Dimming channel	1
Standby	Maximum 0.4 W
Operating Temperature	0 °C to 35 °C
Neutral conductor	Not required
Connecting terminals	Maximum 2 x 2.5 mm <sup>2</sup> solid or stranded types
Extension units	Maximum 10 push buttons
Length of all cable sections	Maximum 50 m for 3-wire NYM cable
Fuse protection	16 A circuit breaker
Operating frequency	2405 - 2480 MHz
Max. radio-frequency power transmitted	<10 mW
IP rating	IP20
Product dimensions (H x W x D)	43 x 43 x 22 mm
Wall box dimension	<b>i</b> The wall box must have a minimum depth of 70 mm.
Certification	Zigbee 3.0
Compliance	

### Trademarks

- Zigbee® is a registered trademark of the Zigbee Alliance.
- Apple® and App Store® are brand names or registered trademarks of Apple Inc.
- Google Play™ Store and Android™ are brand names or registered trademarks of Google Inc.
- Wisier™ is a trademark and the property of Schneider Electric SE, its subsidiaries and affiliated companies.

Other brands and registered trademarks are properties of their relevant owners.

### Customer care

#### Warranty information

We warrant this product for 2 years. See **Warranty** links below.

#### Schneider Electric (Australia) Pty Ltd

33-37 Port Wakefield Road, Gepps Cross SA 5094

**Customer Care:** 13 73 28

**Email:** customercare.au@se.com

**Warranty:**

<https://www.se.com/au/en/about-us/legal/terms-and-conditions.jsp>  
www.se.com

#### Schneider Electric (NZ) Ltd

Building 6, 60 Highbrook Drive, East Tamaki, Auckland 2013

**Customer Care:** 0800 652 999

**Email:** sales@nz.schneider-electric.com

**Warranty:**

<https://www.se.com/nz/en/about-us/legal/terms-and-conditions.jsp>  
www.se.com