

Catalogue No: **PC 281918 G**

TERMINAL BOX SOLID PC IP66/67 H190 x W280 x D180mm GREY

Enclosures and Climate Control > Standard Enclosures > Terminal Boxes > Thermoplastic Terminal Boxes > Solid Range > Solid PC Enclosures with Grey Cover (Mounting Plates Sold Separately)



Representative Photo Only
(actual product may vary based on configuration selections)

Enclosure Terminal Box Solid PC IP66/67 Grey W280xH190xD180mm

- IP66/67 rated, PC: IK08 (side surface) IK09 (front surface), ABS: IK08
- Halogen free, impact resistant polycarbonate or ABS
- Totally insulated, polyurethane gasket and polyamide screws
- Grey RAL 7035 coloured base with option of transparent or grey cover
- RoHS compliant

SPECIFICATIONS

Product Series	Solid
Material, Body / Housing	PC (Polycarbonate) material
Height	188 mm
Width	278 mm
Depth	180 mm
Depth, Base	100 mm
IK Rating, Side	IK08
IK Rating, Front	IK09
IK Rating	IK09
IP Rating	IP66 IP67
Colour, Body / Housing	Light Grey (RAL 7035) colour
Colour, Cover	Grey colour
Electrical Insulation	Totally insulated
Halogen Free	Yes
UV Rating	UL 508
Flammability Rating (UL94)	UL 746C
Glow Wire Rating	IEC 60695-2-1 960°C
Material, Gasket / Seal	PUR / PU material
Material, Screws / Fastening	Polyamide Screws/Fastening
Standards Compliance	EN 60529 EN 60950 EN 62208:2003 EN 62262 UL 508 UL 746C IEC 60695-2-1 960°C
Certifications	GOST-R RoHS

Catalogue No: **PC 281918 G**

TERMINAL BOX SOLID PC IP66/67 H190 x W280 x D180mm GREY

Enclosures and Climate Control > Standard Enclosures > Terminal Boxes > Thermoplastic Terminal Boxes > Solid Range > Solid PC Enclosures with Grey Cover (Mounting Plates Sold Separately)



REFERENCES	
IECEX Certificate	-
Supplier Declaration of Conformity:	-
Installation Guide:	-
User Manual:	-
Manufacturer Datasheet:	-
Manufacturer Catalogue & Product Selection:	-

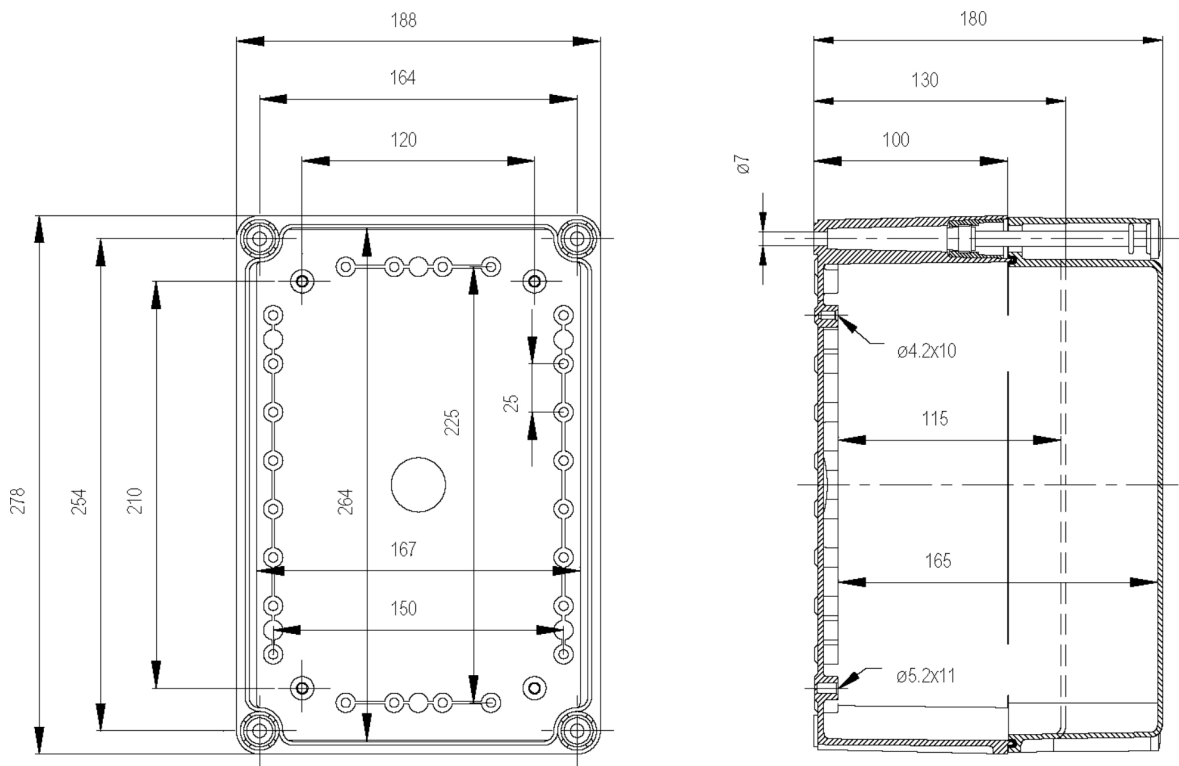

Dimension Diagram