

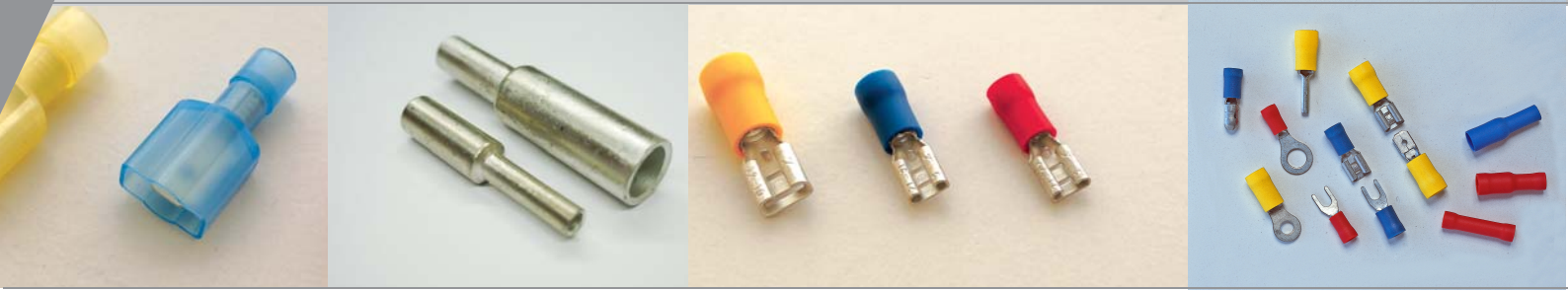

Copper Crimp Lugs and Links
Pre-Insulated and Uninsulated
Terminals and Connectors



Copper Lugs & HD Terminals

All Termco Heavy Duty Copper Tube Lugs & Sheet Terminals are made to the highest possible specifications and are Electro Tinned finished. Only the highest grade Oxygen Free copper is used, with a conductivity of 99.9% by I.A.C.S. Standards.

The Termco range is manufactured to Australian Dimensions, complies with Australian Standard AS/NZ4325.1 and is fully compatible with existing Australian Tooling.

Pre-Insulated & Non-Insulated Compression Terminals

The Termco range of Pre-Insulated and Non-Insulated Compression Terminals has been designed and manufactured under the highest standards to provide terminals that comply with most international codes and standards.

The terminal range, along with the technical specifications has the full endorsed recognition of the Underwriters Laboratory and the Canadian Standards Association.

This includes both the compression and disconnect terminals.

Termco Terminals are easy entry designed, saving time and money and ensuring the right termination - every time!

1. Easy entry guides cable strands into position



2. Eliminates cable strand flares when inserted

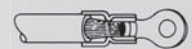

3. Ensures fast, positive and consistent insulation



Termco Size Codings:

No. 1	Red Insulation	Conductor Size	0.5 – 1.5 mm²	22 – 16 AWG
No. 2	Blue Insulation	Conductor Size	1.5 - 2.5 mm²	16 – 14 AWG
No. 3	Yellow Insulation	Conductor Size	2.5 - 6.0 mm²	12 – 04 AWG

Contents

Copper Crimp Lugs and Links	2
Copper Crimp Lugs	2
Copper Bell Mouth Lugs	4
Copper Crimp Links (Butts)	5
Reducing Links	5
Long Palm, Long Barrel Lugs	6
Narrow Palm Circuit Breaker Lugs	6
Pre-Insulated and Uninsulated Terminals and Connectors	7
Ring Terminals	7
Blade Terminals	8
Fork Terminals	8
Push on Female Terminals	9
Push on Male Terminals	9
Flanged Fork Terminals	10
Hooked Blade Terminals	10
Connectors	11
Pin Terminals	11
Cord End Terminals (Boot Lace) Insulated	12
Cord End Terminals (Boot Lace) Non Insulated	13
Dual Cable Cord End Terminals	13
Reel – Cord End Terminals	13

Copper Crimp Lugs and Links

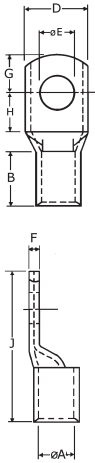

Copper Crimp Lugs Conductor Size: 1.5 – 630 mm ²													
Part Number	Cable Size mm ²	Stud Size mm	A/F Hex Die Size	Dimensions mm								Pack Qty	
				ØA	B	D	ØE	F	G	H	J		
TCL 1.5-4	1.5	4	N/A	1.8	7.5	8	4.2	1	4	5	18.5	100	
TCL 1.5-5		5				8	5.2	1	4	5	18.5		
TCL 1.5-6		6				10	6.2	0.8	5	6	20.5		
TCL 2.5-4	2.5	4		2.4	7	8	4.2	1	4	5	18		100
TCL 2.5-5		5				10	5.2	0.8	5	6	20		
TCL 2.5-6		6				10	6.5	0.8	5	6	20		
TCL 2.5-8		8				11	8.2	0.7	6.5	8.5	24		
TCL 4-4	4	4		3.1	9	10	4.2	1	5	6	23		100
TCL 4-5		5				10	5.2	1	5	6	22		
TCL 4-6		6				10	6.2	1	5	6	22		
TCL 4-8		8				12	8.2	0.8	6.5	8.5	26		
TCL 4-10	10	12		10.2	0.8	6.5	10.5	32	100				
TCL 6-4	6	4	4.4	3.8	9	10	4.2	1.2		5	7	22.5	
TCL 6-5		5				10	5.2	1.2		5	6	23	
TCL 6-6		6				12	6.5	1		6	9	27	
TCL 6-8		8				12	8.4	1	5.5	9.5	27		
TCL 6-10		10				16	10.2	0.8	9	11	32		
TCL 10-4	10	4	5.7	4.7	10	11	4.2	1.8	6	8	27	100	
TCL 10-5		5				12	5.2	1.8	6	8	27		
TCL 10-6		6				12	6.5	1.8	6	8	27		
TCL 10-8		8				14	8.4	1.6	7	9	29		
TCL 10-10		10				16	10.5	1.4	8.5	10.5	32		
TCL 10-12		12				18	13	2.4	-	-	-		
TCL 16-5	16	5	6.3	5.5	19	11	5.2	2	6	9	37	100	
TCL 16-6		6				11	6.5	2.4	6	8	37		
TCL 16-8		8				14	8.4	1.7	7	9	39		
TCL 16-10		10				16	10.5	1.5	8	10	41		
TCL 16-12		12				18	13	2.4	10	13	46		
TCL 25-5	25	5	7.7	7.1	21	13.5	5.2	2	7	12	41	50	
TCL 25-6		6				13.5	6.5	2.4	7	9	41		
TCL 25-8		8				13.5	8.4	2.4	7	9	41		
TCL 25-10		10				16	10.5	1.9	9	10	44		
TCL 25-12		12				18	13	1.6	10	13	48		
TCL 35-5	35	5	9.2	8.2	21	16	5.2	2.4	8	10	44	50	
TCL 35-6		6				16	6.5	3	8	10	44		
TCL 35-8		8				16	8.4	3	8	10	44		
TCL 35-10		10			18	10.5	2.6	9	11	46			
TCL 35-12		12			20	13	2.2	11	13	51			
TCL 35-16		16			23	17	1.8	13	18	58			

Copper Crimp Lugs (continued)

Part Number	Cable Size mm ²	Stud Size mm	A/F Hex Die Size	Dimensions mm								Pack Qty
				∅A	B	D	∅E	F	G	H	J	
TCL 50-6	50	6	10.4	9.5	22	18	6.5	3.3	9	11	48	50
TCL 50-8		8				18	8.4	3.3	9	11	48	
TCL 50-10		10				18	10.5	3.3	9	11	48	
TCL 50-12		12				21	13	2.7	11	13	52	
TCL 50-16		16				25	17	2	14	15	57	
TCL 70-6	70	6	11.5	11.2	24	21	6.5	3.5	11	13	54	35
TCL 70-8		8				21	8.4	3.5	11	13	54	
TCL 70-10		10				21	10.5	3.5	11	13	54	
TCL 70-12		12				21	13	3.5	11	13	54	
TCL 70-16		16				28	17	3.5	14	16	64	
TCL 95-6	95	6	14.2	13.4	27	25	6.5	4	12	14	60	25
TCL 95-8		8				25	8.4	4	12	14	60	
TCL 95-10		10				25	10.5	4	12	14	60	
TCL 95-12		12				25	13	4	12	14	60	
TCL 95-16		16				28	17	3.4	14	16	64	
TCL 120-8	120	8	16.5	15.6	30	29.5	8.4	5	12	14	64	15
TCL 120-10		10				29.5	10.5	5	12	14	64	
TCL 120-12		12				29.5	13	5	12	14	64	
TCL 120-16		16				29.5	17	5	14	16	68	
TCL 120-20		20				32	21	3.5	20	23	83.5	
TCL 150-10	150	10	18.3	16.7	30	32	10.5	5.8	16	16	71	12
TCL 150-12		12				32	13	5.8	20	21	80	
TCL 150-16		16				32	17	5.8	20	21	80	
TCL 185-10	185	10	20	18.4	32	34.8	10.5	5.8	16	16	74	10
TCL 185-12		12				34.8	13	5.8	20	21	83	
TCL 185-16		16				34.8	17	5.8	20	21	83	
TCL 240B	240	-	23.1	21.2	38	40	-	7	G+H=42		92	12
TCL 240-10		10				40	10.5	7	21	21	92	
TCL 240-12		12				40	13	7	21	21	92	
TCL 240-14		14				39	15	7	21	21	92	
TCL 240-16		16				40	17	7	21	21	92	
TCL 300B	300	-	26	23.5	42	44.7	-	7.8	G+H=46		101	9
TCL 300-12		12				44.7	13	7.8	23	23	101	
TCL 300-16		16				44.7	17	7.8	23	23	101	
TCL 400B	400	-	28.1	26.8	44	50	-	8	G+H=52		114	5
TCL 400-12		12				50	13	8	23	27	116	
TCL 400-16		16				50	17	8	24	26	116	
TCL 400-20		20				50	21	8	25	25	116	
TCL 500B	500	-	31	30	48	56	-	9	G+H=56		124	4
TCL 500-12		12				56	13	9	24	31	128	
TCL 500-16		14				56	17	8	25	32	129	
TCL 630B	630	-	37	34	56	64.4	-	11	G+H=56		134	3
TCL 630-12		12				64.4	13	10	28	31	140	
TCL 630-20		20				64.4	21	10	28	31	140	

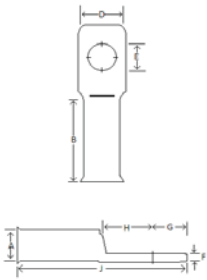

Copper Bell Mouth Lugs

Part Number	Cable Size mm ²	Stud Size mm	A/F Hex Die Size	Dimensions mm								Pack Qty
				∅A	B	D	∅E	F	G	H	J	
TCLB 10-8	10	8	5.7	4.7	10	13	8.4	1.7	7	9	29	100
TCLB 10-10		10				16	10.5	1.5	9	10	38	
TCLB 16-6	16	6	6.3	5.5	19	11	6.5	2.4	6	8	37	50
TCLB 16-8		8				14	8.4	1.7	7	9	39	
TCLB 16-10		10				16	10.5	1.5	8	10	41	
TCLB 16-12		12				17	13	1.2	11	12	48	
TCLB 25-6	25	6	7.7	7.1	21	13.5	6.5	2.4	7	9	41	50
TCLB 25-8		8				13.5	8.4	2.4	7	9	41	
TCLB 25-10		10				16	10.5	1.9	9	10	44	
TCLB 25-12		12				18	13	1.7	10	13	49	
TCLB 35-6	35	6	9.2	8.2	21	16	6.5	3	8	10	44	50
TCLB 35-8		8				16	8.4	3	8	10	44	
TCLB 35-10		10				18	10.5	2.6	9	11	46	
TCLB 35-12		12				20	13	2.2	10	12	51	
TCLB 50-8	50	8	10.4	9.5	22	18	8.4	3.3	9	11	48	50
TCLB 50-10		10				18	10.5	3.3	9	11	48	
TCLB 50-12		12				21	13	2.7	11	13	52	
TCLB 70-8	70	8	11.5	11.2	24	21	8.4	3.5	11	13	54	35
TCLB 70-10		10				21	10.5	3.5			54	
TCLB 70-12		12				21	13	3.5			54	
TCLB 95-8	95	8	14.2	13.4	27	25	8.4	3.6	12	14	60	25
TCLB 95-10		10				25	10.5	4				
TCLB 95-12		12				25	13	4				
TCLB 120-8	120	8	16.5	15.6	30	29	8.4	4.9	12	14	65	15
TCLB 120-10		10				29.5	10.5	5			64	
TCLB 120-12		12				29.5	13	5			64	
TCLB 150-10	150	10	18.3	16.7	30	32	10.5	5.8	16	16	71	12
TCLB 150-12		12					13	5.8	20	21	80	
TCLB 185-10	185	10	20	18.4	32	34.8	10.5	5.8	16	16	74	12
TCLB 185-12		12					13	5.8	20	21	83	
TCLB 240B	240	-	23.1	21.2	38	40	-	7	G+H=42		92	10
TCLB 240-12		12					13	7			92	
TCLB 300B	300	-	26	23.5	42	44.7	-	7.8	G+H=46		101	9

Reducing Links

Part Code	Conductor Area mm ²	Large End Dimensions			Small End Dimensions		Pack Qty
		A	B	ID	C	ID	
TCLRL16-6	16 - 6	55	27	5.5	28	3.7	100
TCLRL16-10	16 - 10	55	27	5.5	28	4.5	
TCLRL25-6	25 - 6	56	27	7.2	29	3.7	50
TCLRL25-10	25 - 10	56	27	7.2	29	4.5	
TCLRL25-16	25-16	56	28	7.2	29	5.5	
TCLRL35-10	35 - 10	56	27	8.5	29	4.5	
TCLRL35-16	35 - 16	56	28	8.5	29	5.5	
TCLRL35-25	35 - 25	56	28	8.5	28	7.2	
TCLRL50-16	50 - 16	58	28	9.5	30	5.5	75
TCLRL50-25	50 - 25	58	28	9.5	30	7.2	
TCLRL50-35	50 - 35	58	29	9.5	30	8.5	
TCLRL70-25	70 - 25	58	28	11	30	7.2	25
TCLRL70-35	70 - 35	58	29	11	30	8.5	
TCLRL70-50	70 - 50	58	29	11	30	9.5	
TCLRL95-35	95 - 35	75	29	13.5	46	8.5	40
TCLRL95-50	95 - 50	75	29	13.5	46	9.5	
TCLRL95-70	95 - 70	75	30	13.5	46	11	
TCLRL120-50	120 - 50	75	29	15	46	9.5	20
TCLRL120-70	120 - 70	75	30	15	46	11	
TCLRL120-95	120 - 95	88	44	15	44	13.5	
TCLRL150-70	150 - 70	77	30	16.5	48	11	
TCLRL150-95	150 - 95	90	44	16.5	46	13.5	
TCLRL150-120	150 - 120	90	44	16.5	46	15	

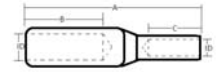

Copper Crimp Links (Butts) Conductor Size: 1.5 – 630 mm²

Part Number	Dimensions mm		Cable Size mm ²	Pack Qty	Part Number	Dimensions mm		Cable Size mm ²	Pack Qty
	A	C				A	C		
TCLK 1.5	22	1.8	1.5	100	TCLK 95	54	13.4	95	25
TCLK 2.5	22	2.4	2.5		TCLK 120	66	15.6	120	15
TCLK 4	22	3.1	4		TCLK 150	66	16.7	150	10
TCLK 6	22	3.8	6		TCLK 185	66	18.4	185	5
TCLK 10	22	4.7	10		TCLK 240	91	21.2	240	1
TCLK 16	44	5.5	16		TCLK 300	91	23.5	300	
TCLK 25	48	7.1	25	TCLK 400	91	26.8	400		
TCLK 35	48	8.2	35	TCLK 500	112	30	500		
TCLK 50	48	9.5	50	TCLK 630	112	34	630		
TCLK 70	52	11.2	70	35					

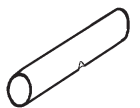
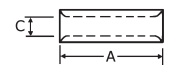

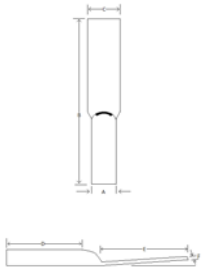

Long Palm, Long Barrel Lugs Conductor Size: 1.5 – 630 mm ²									
Part Number	Cable Size mm ²	Dimensions mm						A/F Hex Die Size	Pack Qty
		∅A	B	C	D	E	F		
TCLLPLB 16	16	5.5	86	16	40	61	1.5	6.3	50
TCLLPLB 25	25	7.1	95	16	40	61	1.9	7.7	
TCLLPLB 35	35	8.2	112	18	45	72	2.6	9.2	
TCLLPLB 50	50	9.5	130	18.2	50	80	3.3	10.4	25
TCLLPLB 70	70	11.2	154	21.1	50	100	3.5	11.5	1
TCLLPLB 95	95	13.4	161	25	50	100	3.9	14.2	
TCLLPLB 120	120	15.6	168	28.5	50	100	5	16.5	
TCLLPLB 150	150	16.7	169	32	50	100	5.8	18.3	
TCLLPLB 185	185	18.4	174	35	55	100	5.8	20	
TCLLPLB 240	240	21.2	192	40	90	100	7.1	23.1	
TCLLPLB 300	300	23.5	208	45	90	105	7.7	26	
TCLLPLB 400	400	26.8	228	50	70	110	7.8	28.1	
TCLLPLB 500	500	30	235	56	70	110	8.5	31	
TCLLPLB 630	630	34	247	65	70	110	10.9	37	

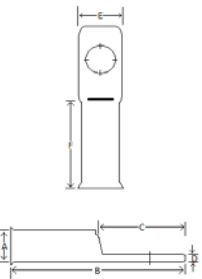

Narrow Palm Circuit Breaker Lugs Conductor Size: 35 – 300 mm ²									
Part Number	Cable Size mm ²	Dimensions mm						A/F Hex Die Size	Pack Qty
		∅A	B	C	D	E	F		
TCLNP 35-6	35	8.2	41	15	3	15	21	9.2	50
TCLNP 50-6	50	9.5	43	15	3.2	15	22	10.4	
TCLNP 50-8			47	21		19			
TCLNP 50-10			49	21		19			
TCLNP 70-6	70	11.2	45	15	3.3	17	24	11.5	35
TCLNP 70-8			51	21		19			
TCLNP 70-10			51	21		19			
TCLNP 95-8	95	13.4	51	17	3.9	19	27	14.2	25
TCLNP 95-10			55	21					
TCLNP 120-8	120	15.6	61	23	5	19	30	16.5	15
TCLNP 120-10									
TCLNP 150-8	150	16.7	66	27	5.5	19	30	18.3	
TCLNP 150-10									
TCLNP 185-10	185	18.4	74	32	5.7	31	32	20	12
TCLNP 240-10	240	21.2	82	32	7.1	31	38	23.1	
TCLNP 240-12			86						
TCLNP 300-10	300	23.5	87	32	7.8	31	42	26	9
TCLNP 300-12			89	36	9				

Pre-Insulated and Uninsulated Terminals and Connectors

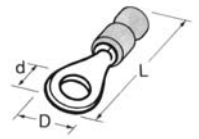

Ring Terminals Conductor Size: 0.5 – 6.0 mm ²							
Part Number			Dimensions			Length (L)	
Nylon Insulated	Nylon Twin Grip Insulated	Non Insulated	Stud Size	d	D	Insulated	Non Insulated
No 1 (Red) Terminals							
TVR 1-3	TVR 1-3TG	TR 1-3	3	3.2	5.5	17.7	11.7
		TR 1-3.7	3.5	3.7	5.5	17.7	11.7
TVR 1-4	TVR 1-4TG	TR 1-4	4	4.3	6.6	20.6	14.6
TVR 1-4L		TR 1-4L	4	4.3	8	22	16
TVR 1-5	TVR 1-5TG	TR 1-5	5	5.3	8	22	16
TVR 1-6	TVR 1-6TG	TR 1-6	6	6.4	11.6	27.8	21.8
TVR 1-8	TVR 1-8TG	TR 1-8	8	8.4	11.6	27.8	21.8
TVR 1-10	TVR 1-10TG	TR 1-10	10	10.5	13.6	31.7	25.7
TVR 1-12	TVR 1-12TG		12	13	19.2	36.6	30.6
No 2 (Blue) Terminals							
TVR 2-3	TVR 2-3TG	TR 2-3	3	3.2	6.4	18.5	12.5
TVR 2-3L		TR 2-3L	3	3.2	8.5	22	16.8
TVR 2-3.7		TR 2-3.7	3.5	3.7	6.6	20.5	14.5
TVR 2-4	TVR 2-4TG	TR 2-4	4	4.3	6.6	20.5	14.5
TVR 2-5	TVR 2-5TG	TR 2-5	5	5.3	8.5	23	17
TVR 2-6	TVR 2-6TG		6	6.4	12	28	22
TVR 2-8	TVR 2-8TG		8	8.4	12	28	22
TVR 2-10	TVR 2-10TG		10	10.5	13.6	31.7	25.7
TVR 2-12	TVR 2-12TG	TR 2-12	12	13	19.2	36.6	30.6
No 5 (Yellow) Terminals							
TVR 5-3			3	3.2	7.2	22.5	15.5
TVR 5-3.7			3.5	3.7	7.2	22.5	15.5
TVR 5-4	TVR 5-4TG	TR 5-4	4	4.3	7.2	22.5	15.5
TVR 5-5	TVR 5-5TG	TR 5-5	5	5.3	9.5	26	19
TVR 5-6	TVR 5-6TG	TR 5-6	6	6.4	12	29.5	22.5
TVR 5-8L	TVR 5-8LTG		8	8.4	15	34.2	27.2
TVR 5-10	TVR 5-10TG		10	10.5	15	34.2	27.2
TVR 5-12	TVR 5-12TG		12	13	19.2	38.6	

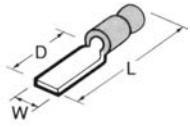

Blade Terminals Conductor Size: 0.5 – 6.0 mm²

Part Number			Dimensions		Length (L)	
Nylon Insulated	Vinyl Twin Grip Insulated	Non Insulated	D	W	Insulated	Non Insulated
No 1 (Red) Terminals						
TVB 1-10	TVB 1-10TG		10.7	2.4	21.7	15.7
TVB 1-18	TVB 1-18TG		18	2.4	29	23
TVB 1-11	TVB 1-11TG		11	3	22	16
TVB 1-14	TVB 1-14TG		14	3	25	19
No 2 (Blue) Terminals						
TVB 2-9	TVB 2-9TG		9	2.8	20	14
TVB 2-18	TVB 2-18TG		18	23.4	29	23
No 5 (Yellow) Terminals						
TVB 5-10	TVB 5-10TG		10	2.8	23	16
	TVB 5-14TG		14	4.5	27	

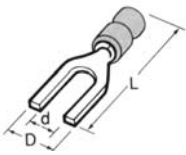

Fork Terminals Conductor Size: 0.5 – 6.0 mm²

Part Number			Dimensions			Length (L)	
Nylon Insulated	Vinyl Twin Grip Insulated	Non Insulated	Stud Size	d	D	Insulated	Non Insulated
No 1 (Red) Terminals							
TVF 1-3	TVF 1-3TG		3	3.2	5.8	22	16
TVF 1-3N	TVF 1-3NTG		3.5	3.7	6.4	21.6	15.6
TVF 1-4N	TVF 1-4NTG	TF 1-4N	4	4.3	6.4	21.6	15.6
TVF 1-4	TVF 1-4TG		4	4.3	7.2	22	16
TVF 1-5	TVF 1-5TG		5	5.3	9.5	22	16
TVF 1-6	TVF 1-6TG		6	6.4	12	28.2	22.2
No 2 (Blue) Terminals							
TVF 2-3	TVF 2-3TG		3	3.2	5.8	22	16
TVF 2-3N	TVF 2-3NTG		3.5	3.7	6.4	22	16
TVF 2-4N			4	4.3	6.4	22	16
TVF 2-4	TVF 2-4TG	TF 2-4	4	4.3	7.2	22.2	16.2
TVF 2-5	TVF 2-5TG	TF 2-5	5	5.3	9.5	23	17
TVF 2-6	TVF 2-6TG		6	6.4	12	28.2	22.2
No 5 (Yellow) Terminals							
TVF 5-3			3	3.2	8.3	25.2	19.5
TVF 5-4	TVF 5-4TG		4	4.3	8.5	25.7	18.7
TVF 5-4L	TVF 5-4LTG		4	4.3	9.5	25.7	
TVF 5-5	TVF 5-5TG	TF 5-5	5	5.3	9.5	25.7	18.7
TVF 5-6	TVF 5-6TG	TF 5-6	6	6.4	12	31.7	24.7

Push on Female Terminals Quick Connect Receptacles

Part Number			Dimensions		
Vinyl Half Insulated	Fully Insulated	Insulation Colour	Tin Plated Insulated	Conductor Size mm ²	Suit Tab Width mm ²
No 1 (Red) Terminals					
TVPO 1-2.5F5	TNFPO 1-2.8F5	Red		0.5 - 1.5	2.8 x 0.5
TVPO 1-2.8F8	TNFPO 1-2.8F8	Red	TPO 1-2.8F8	0.5 - 1.5	2.8 x 0.8
	TVFPO 1-2.8F8	Red		0.5 - 1.5	2.8 x 0.8
TVPO 1-4.8F5	TVFPO 1-4.8F5	Red	TPO 1-4.8F5	0.5 - 1.5	4.8 x 0.5
TVPO 1-4.8F8	TVFPO 1-4.8F8	Red		0.5 - 1.5	4.8 x 0.8
TVPO 1-6.3F	TVFPO 1-6.3F	Red	TPO 1-6.3F	0.5 - 1.5	6.3
	TNFPO 1-6.3F	Red		0.5 - 1.5	6.3
No 2 (Blue) Terminals					
TVPO 2-2.8F8	TVFPO 2-2.8F8	Blue	TPO 2-2.8F8	1.5 - 2.5	2.8 x 0.8
TVPO 2-4.8F5	TVFPO 2-4.8F5	Blue	TPO 2-4.8F5	1.5 - 2.5	4.8 x 0.5
TVPO 2-4.8F8	TVFPO 2-4.8F8	Blue	TPO 2-4.8F8	1.5 - 2.5	4.8 x 0.8
TVPO 2-6.3F	TVFPO 2-6.3F	Blue	TPO 2-6.3F	1.5 - 2.5	6.3
	TNFPO 2-6.3F	Blue		1.5 - 2.5	6.3
No 5 (Yellow) Terminals					
TVPO 5-6.3F	TVFPO 5-6.3F	Yellow	TPO 5-6.3F	2.5 - 6.0	6.3
TVPO 5-9.5F		Yellow	TPO 5-9.5F	2.5 - 6.0	9.5



Vinyl Half Insulated



Vinyl Fully Insulated

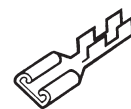

Non Insulated

Push on Male Terminals Quick Connect Tabs

Part Number			Dimensions mm				
Vinyl Insulated	Insulation Colour	Non Insulated	Tab Width	Tab Thick	Length	Conductor Size mm ² Insulated	Conductor Size mm ² Non Insulated
No 1 (Red) Terminals							
TVPO 1-4.8M	Red		4.8	0.8	9.5	0.5 - 1.5	
TVPO 1-6.3M	Red	TPO 1-6.3M	6.3	0.8	9.5	0.5 - 1.5	0.3 - 0.75
No 2 (Blue) Terminals							
TVPO 2-4.8M	Blue		4.8	0.8	9.5	1.5 - 2.5	
TVPO 2-6.3M	Blue	TPO 2-6.3M	6.3	0.8	9.5	1.5 - 2.5	1.0 - 2.5
No 5 (Yellow) Terminals							
TVPO 5-6.3M	Yellow		6.3	0.8	9.5	2.5 - 6.5	



Vinyl Insulated

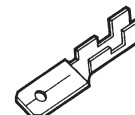

Non Insulated

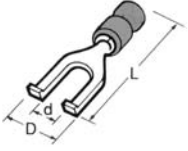

Flanged Fork Terminals Conductor Size: 0.5 – 6.0 mm²

Part Number			Dimensions			Length (L)	
Nylon Insulated	Vinyl Insulation Colour	Non Insulated	Stud Size	d	D	Insulated	Non Insulated
No 1 (Red) Terminals							
TVF 1-3F	Red		3.5	3.7	7.2	20.5	14.5
TVF 1-4F	Red		4	4.3	7.2	20.5	14.5
No 2 (Blue) Terminals							
TVF 2-3F	Blue		3.5	3.7	7.2	20.7	14.7
TVF 2-4F	Blue		4	4.3	7.2	20.7	14.7
TVF 2-5F	Blue		5	5.3	8.5	21.5	14.5

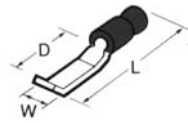

Hooked Blade Terminals Conductor Size: 0.5 – 6.0 mm²

Part Number			Dimensions		Length (L)		
Nylon Insulated	Vinyl Twin Grip Insulated	Non Insulated	D	W	Insulated		Non Insulated
					Nylon	Vinyl	
No 1 (Red) Terminals							
TVB 1-13H	TVB 1-13HTG		18	3	28	29	23
TVB 1-13HW			18	4.7	28	29	23
No 2 (Blue) Terminals							
TVB 2-13H	TVB 2-13HTG		18	3	28	29	23
TVB 2-13HW			18	4.7	28	29	23
	TVB 2-18HTG		18	3	28	29	23
No 5 (Yellow) Terminals							
TVB 5-13H	TVB 5-13HTG		17.5	3	30	30.5	23
TVB 5-13HW			17.5	4.7	30	30.5	23

Connectors Conductor Size: Red 0.5 – 1.5mm Blue 1.5 – 2.5mm Yellow 2.5 – 6.0mm²

Butt Connectors

Part Number				Dimensions		Length (L)	
Vinyl Insulated	Nylon Twin Grip Insulated	Insulation Colour	Non Insulated	D	d	Insulated	Non Insulated
TVBC 1	TNBC 1TG	Red	TBC 1	3.3	1.7	22.7	15
TVBC 2	TNBC 2TG	Blue	TBC 2	4	2.3	22.7	15
TVBC 5	TNBC 5TG	Yellow	TBC 5	5.5	3.4	26.7	15

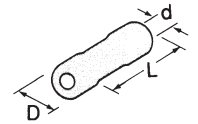

Parallel Connectors

Part Number				Dimensions		Length (L)	
Insulated	Weather Proof Heatshrink	Insulation Colour	Non Insulated	D	d	Insulated	Non Insulated
TVPC 1	THSB 1	Red	TPC 1	3.3	1.7	16	8
TVPC 2	THSB 2	Blue	TPC 2	4	2.3	16	8
TVPC 5	THSB 5	Yellow	TPC 5	5.5	3.4	20.5	8.5

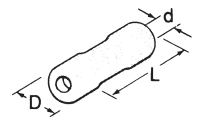

Closed End Connectors (Insulated)

Part Number		Dimensions		Length (L)	Conductor Size mm ²
Insulated	Insulation Colour	D	d		
CE-1	Clear	6.4	4.9	15.3	1 - 1.75
CE-2	Clear	6.6	5.7	15.3	1 - 2.5
CE-5	Clear	9.4	7.2	17.1	2 - 5.5
CE-8	Clear	12	4.7	27.8	4 - 9

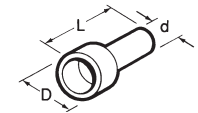

Pin Terminals Conductor Size: 0.25 – 6.64 mm²

Part Number			Dimensions		Length (L)	
Insulated	Twin Grip Insulated	Non Insulated	d	D	Insulated	Non Insulated
No 1 (Red) Terminals						
TVP 1-9	TVP 1-9TG		1.9	9	18.5	14.3
TVP 1-12	TVP 1-12TG	TP 1-12	1.9	12	21.2	17
No 2 (Blue) Terminals						
TVP 2-9	TVP 2-9TG		1.9	9	18.5	14.3
TVP 2-12	TVP 2-12TG	TP 2-12	1.9	12	21.2	17
No 5 (Yellow) Terminals						
TVP 5-14	TVP 5-14TG	TP 5-14	2.9	14	27.2	20

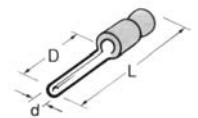

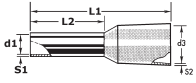

Cord End Terminals (Boot Lace) Insulated, Size: 0.25 – 95mm ²								
Part Number	Colour	mm ²	d1	S1	d3	S2	L1	L2
TICE 1125	Violet	0.25	0.8	0.15	2	0.25	10.4	6
TICE 1134	Pink	0.34	0.8	0.15	2	0.25	10.4	6
TICE 0505/6	White	0.5	1	0.15	2.65	0.25	12	6
TICE 0505							14	8
TICE 0505/10							16	10
TICE 7575/6	Blue	0.75	1.2	0.15	3	0.25	12.4	6
TICE 7575							14.6	8.2
TICE 7575/10							16.4	10
TICE 7575/12							18.4	12
TICE 1010	Red	1	1.4	0.15	3.3	0.25	14.6	8.2
TICE 1515	Black	1.5	1.7	0.15	3.5	0.25	14.6	8.2
TICE 1515/10							16.4	10
TICE 1515/12							18.4	12
TICE 1515/18							24.4	18
TICE 2525	Grey	2.5	2.2	0.15	4	0.25	15.2	8.2
TICE 2525/12							19	12
TICE 2525/18							25	18
TICE 4040	Orange	4	2.8	0.2	4.5	0.3	16.5	9
TICE 4040/18							25.5	18
TICE 6040	Green	6	3.5	0.2	6.3	0.3	20	12
TICE 6040/18							26	18
TICE 0010	Brown	10	4.5	0.2	7.6	0.4	21.5	12
TICE 0010/18							27.5	18
TICE 0016	Ivory	16	5.8	0.2	8.8	0.4	22.2	12
TICE 0016/18							28.2	18
TICE 0025	Black	25	7.3	0.2	11.2	0.4	29	16
TICE 0025/22							35	22
TICE 0035	Red	35	8.3	0.3	12.7	0.4	28	16
TICE 0035/25							28	25
TICE 0050	Blue	50	10.3	0.3	15	0.5	34	20
TICE 0050/25							34	25
TICE 0070	Yellow	70	13.5	0.3	16	0.5	35	20
TICE 0095	Red	95	14.5	0.7	16	0.5	42	25

In accordance with DIN Standard 46228 Part 4, suitable for tri-rated cables.

Cord End Terminals (Boot Lace) Non Insulated

Part Number	Cable Size mm ²	D1	L2	S1	Part Number	Cable Size mm ²	D1	L2	S1
TUCE 0505	0.5	1	6	0.15	TUCE 0010	10	4.5	15	0.2
TUCE 7575	0.75	1.2	10	0.15	TUCE 0010/18	10	4.5	18	0.2
TUCE 1010	1	1.4	10	0.15	TUCE 0016	16	5.8	15	0.2
TUCE 1515/8	1.5	1.7	8	0.15	TUCE 0016/18	16	5.8	18	0.2
TUCE 1515	1.5	1.7	10	0.15	TUCE 0025	25	7.3	15	0.2
TUCE 2525/8	2.5	2.2	8	0.15	TUCE 0025/18	25	7.3	18	0.2
TUCE 2525	2.5	2.2	12	0.15	TUCE 0035	35	8.3	20	0.3
TUCE 2525/18	2.5	2.2	18	0.15	TUCE 0050	50	10.3	22	0.3
TUCE 4040	4	2.8	12	0.2	TUCE 0070	70	12.6	26	0.3
TUCE 6040	6	3.6	15	0.2	TUCE 0095	95	15.2	30	0.4

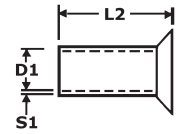

In accordance with DIN Standard 46228 Part 1, suitable for tri-rated cables.

Dual Cable Cord End Terminals Boot Lace Terminals – Insulated with Parallel Sleeve

Part Number	Colour	mm ²	d1	S1	d3	d2	S2	L1	L2
TICE 2005	White	2 x 0.5	1.5	0.15	5.6	3.6	0.25	15	8
TICE 2007	Grey	2 x 0.75	1.8	0.15	6.2	3.6	0.25	15	8
TICE 2010	Red	2 x 1	2	0.15	6	4	0.3	15	8
TICE 2015	Black	2 x 1.5	2.3	0.15	7.2	4.2	0.3	16	8
TICE 2025	Blue	2 x 2.5	2.9	0.15	8.5	5	0.3	18	10
TICE 2040	Lt Grey	2 x 4	3.8	0.2	9.2	5.7	0.35	23	12
TICE 2060	Yellow	2 x 6	4.9	0.2	10.5	6.8	0.35	24	14
TICE 2100	Red	2 x 10	6.5	0.2	13	8	0.4	26	14
TICE 2160	Blue	2 x 16	8.7	0.2	19.3	10.5	0.4	31	14

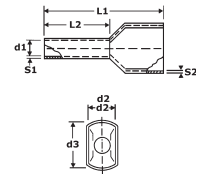

Reel – Cord End Terminals Boot Lace Terminals – Insulated on Continuous Spools

Part Number	Colour	Qty per Reel	mm ²	d1	S1	d3	S2	L1	L2
TCES 05	White	1,000	0.5	1.1	0.15	2.6	0.25	14.5	8
TCES 07	Blue	1,000	0.75	1.3	0.15	2.8	0.25	14.5	8
TCES 10	Red	1,000	1	1.5	0.15	3	0.25	14.5	8
TCES 15	Black	1,000	1.5	1.8	0.15	3.4	0.25	14.5	8
TCES 25	Grey	500	2.5	2.3	0.15	4.2	0.25	14.5	8

